

LOT 604-A
N.W. 1/4 Sec 20 T. 20 N. R. 10 W.
1908

LOT 604-B
S.W. 1/4 Sec 20 T. 20 N. R. 10 W.
1908

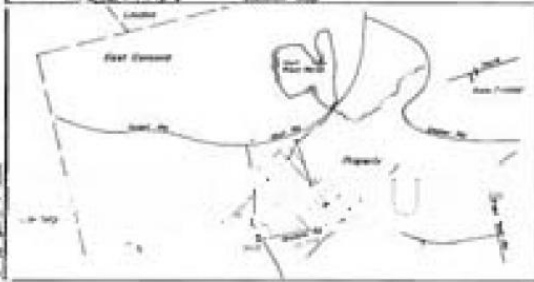

APPROVED
CITY PLANNING BOARD
JAMES M. SEWELL
City Engineer

Legend

- - 1/2" wide of road
- - 1/2" wide of lot
- - 1/2" wide of lot
- - 1/2" wide of lot
- - 1/2" wide of lot
- - 1/2" wide of lot
- - 1/2" wide of lot
- - 1/2" wide of lot

Lot	Area	Shape	Notes
LOT 1	340	10000	sq ft
LOT 2	340	10000	sq ft
LOT 3	340	10000	sq ft
LOT 4	340	10000	sq ft
LOT 5	17	500	acres
LOT 6	26	800	acres